



clients logo

AREA SCHEDULE

APPLICATION SITE AREA: 5992 m<sup>2</sup>  
TOTAL SITE AREA: 8445 m<sup>2</sup>

Sales Area: 1375 m<sup>2</sup>

WAREHOUSE  
Warehouse: 221.8 m<sup>2</sup>  
Freezer: 36.7 m<sup>2</sup>  
Chiller: 57.5 m<sup>2</sup>

ANCILLARY AREA:  
Lobby: 22 m<sup>2</sup>  
Bakery Prep Area: 72.9 m<sup>2</sup>  
Customer Toilets: 6.2 m<sup>2</sup>  
Utilities: 16 m<sup>2</sup>  
Cash Room: 9.6 m<sup>2</sup>  
Stair: 6.1 m<sup>2</sup>  
Internal Wall: 42.9 m<sup>2</sup>  
TOTAL: 1876.7 m<sup>2</sup>

FIRST FLOOR:  
Staff WC: 6.0 m<sup>2</sup>  
IT Room: 9.0 m<sup>2</sup>  
Office: 10.4 m<sup>2</sup>  
Cloak Room: 15.7 m<sup>2</sup>  
Welfare: 29.2 m<sup>2</sup>  
Circulation: 39.0 m<sup>2</sup>  
Internal Wall: 5.4 m<sup>2</sup>  
TOTAL: 114.7 m<sup>2</sup>

TOTAL LIDL GIA: 1991.4 m<sup>2</sup>

LIDL PARKING  
Standard Parking: 76 Spaces  
Disabled Parking: 6 Spaces  
Parent & Child Parking: 7 Spaces  
Electric Charging Point: 2 Spaces

TOTAL PARKING: 91 Spaces

Short Term Cycle stands: 24 Spaces  
Long Term Cycle stands: 14 Spaces  
Total Cycle stands: 38 Spaces

6	09.08.19	PV panels indicated on roof as requested by GL email 08/08/19	WW
5	18.07.19	fire escape repositioned, parking amended to suit	JB
4	15.05.19	Updated to clients requirements	MC
3	28.07.19	Ownership area information added	AW
2	27.07.17	Site area revised	AW
1	02.06.17	Store layouts updated to latest specifications	BB
REV	DATE	DESCRIPTION	BY

IN CASE OF DOUBT OR DISCREPANCIES PLEASE REFER TO ARCHITECT FOR INSTRUCTIONS.  
DRAWING AND SUSTAINABILITY NUMBERS IN ACCORDANCE WITH BS1192:2007.  
THIS DRAWING SHOULD NOT BE SCALED.  
THIS DRAWING IS COPYRIGHT.

SUITABILITY NUMBER KEY:

WP	S0 - Work in Progress*	DOCUMENTATION - SIGN-OFF
SHARED	S1 - Fit for co-ordination**	A - Fit for construction
	S2 - Fit for information	B - Fit for construction, with comments
	S3 - Fit for internal review and comment	C - Comprehensive revisions needed
	S4 - Fit for construction approval	ARCHIVE
		AB - As Built
		FC - Final Construction
DOCUMENTATION	D1 - Fit for costing	* For internal pre-issue usage only.
	D2 - Fit for tender	** For model file usage only.
	D3 - Fit for contractor design	
	D4 - Fit for manufacture/procurement	

4th Floor, Greyfriars House  
Greyfriars Road, Cardiff CF10 3AL  
Tel: 029 2055 8900 Fax: 029 2039 9592  
www.boyesrees.co.uk  
Registered office: As above Reg No. 295 1583 (England & Wales)

PROJECT TITLE:  
Proposed Lidl store at  
Atlas Trade Park,  
Fraser Road  
Erith  
Kent

DRAWING TITLE:  
Proposed First Floor Plan

DRAWN BY: AW SCALE: 1:250 @ A3

JOB NO: 5508 DATE: MAR. 17

SUITABILITY: S0 REVISION: 6

PROJECT	ORIGIN.	VOLUME	LEVEL	TYPE	DISCIP.	NUMBER
5508	BR	V01	00	DR	A	012013

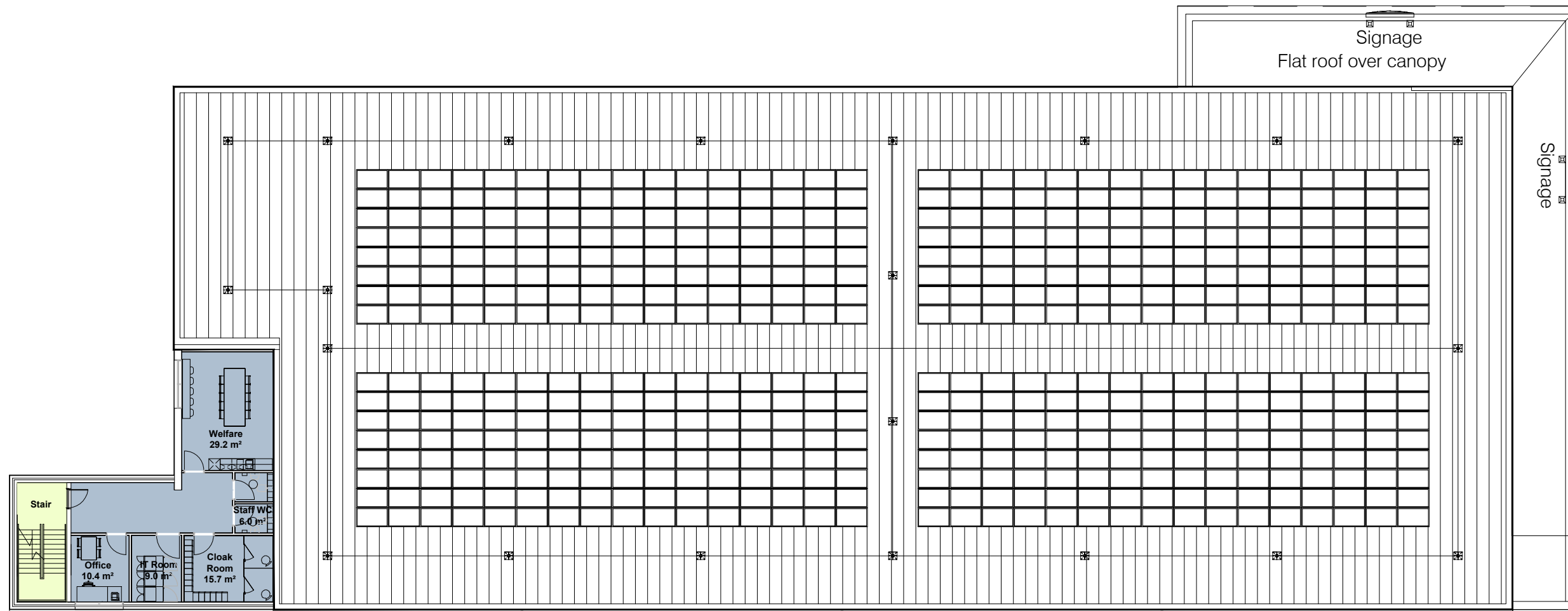

First Floor Plan

