



clients logo

AREA SCHEDULE

APPLICATION SITE AREA: 5992 m<sup>2</sup>  
TOTAL SITE AREA: 8445 m<sup>2</sup>

Sales Area: 1375 m<sup>2</sup>

WAREHOUSE  
Warehouse: 221.8 m<sup>2</sup>  
Freezer: 36.7 m<sup>2</sup>  
Chiller: 57.5 m<sup>2</sup>

ANCILLARY AREA:  
Lobby: 22 m<sup>2</sup>  
Bakery Prep Area: 72.9 m<sup>2</sup>  
Customer Toilets: 6.2 m<sup>2</sup>  
Utilities: 16 m<sup>2</sup>  
Cash Room: 9.6 m<sup>2</sup>  
Stair: 6.1 m<sup>2</sup>  
Internal Wall: 42.9 m<sup>2</sup>  
TOTAL: 1876.7 m<sup>2</sup>

FIRST FLOOR:  
Staff WC: 6.0 m<sup>2</sup>  
IT Room: 9.0 m<sup>2</sup>  
Office: 10.4 m<sup>2</sup>  
Cloak Room: 15.7 m<sup>2</sup>  
Welfare: 29.2 m<sup>2</sup>  
Circulation: 39.0 m<sup>2</sup>  
Internal Wall: 5.4 m<sup>2</sup>  
TOTAL: 114.7 m<sup>2</sup>

TOTAL LIDL GIA: 1991.4 m<sup>2</sup>

LIDL PARKING  
Standard Parking: 76 Spaces  
Disabled Parking: 6 Spaces  
Parent & Child Parking: 7 Spaces  
Electric Charging Point: 2 Spaces

TOTAL PARKING: 91 Spaces

Short Term Cycle stands: 24 Spaces  
Long Term Cycle stands: 14 Spaces  
Total Cycle stands: 38 Spaces

REV	DATE	DESCRIPTION	BY
6	18.07.19	fire escape repositioned, parking amended to suit	JB
5	15.05.19	Updated to clients requirements	MC
4	28.07.17	Ownership area information added	AW
3	27.07.17	Site area revised	AW
2	02.06.17	Store layouts updated to latest specifications	RB
1	21.03.17	Amended to client's comments	AW

IN CASE OF DOUBT OR DISCREPANCIES PLEASE REFER TO ARCHITECT FOR INSTRUCTIONS.  
DRAWING AND SUSTAINABILITY NUMBERS IN ACCORDANCE WITH BS1132:2007.  
THIS DRAWING SHOULD NOT BE SCALED.  
THIS DRAWING IS COPYRIGHT.

SUITABILITY NUMBER KEY:

WIP	S0 - Work in Progress*	DOCUMENTATION - SIGN-OFF
SHARED	S1 - Fit for co-ordination**	A - Fit for construction
	S2 - Fit for information	B - Fit for construction, with comments
	S3 - Fit for internal review and comment	C - Comprehensive revisions needed
	S4 - Fit for construction approval	ARCHIVE
DOCUMENTATION	D1 - Fit for costing	AB - As Built
	D2 - Fit for tender	FC - Final Construction
	D3 - Fit for contractor design	
	D4 - Fit for manufacture/procurement	

\* For internal pre-issue usage only.  
\*\* For model file usage only.

4th Floor, Greyfriars House  
Greyfriars Road, Cardiff CF10 3AL  
Tel: 029 2055 8900 Fax: 029 2039 9592  
www.boyesrees.co.uk  
Registered office: As above Reg No. 295 1583 (England & Wales)

PROJECT TITLE:  
Proposed Lidl store at  
Atlas Trade Park,  
Fraser Road  
Erith  
Kent

DRAWING TITLE:  
Proposed Store Plan - Ground Floor

DRAWN BY: AW SCALE: 1:250 @ A3

JOB NO: 5508 DATE: JUN 17

SUITABILITY: S0 REVISION: 6

PROJECT	ORIGIN	VOLUME	LEVEL	TYPE	DISCIP.	NUMBER
5508	BR	V01	00	DR	A	012011

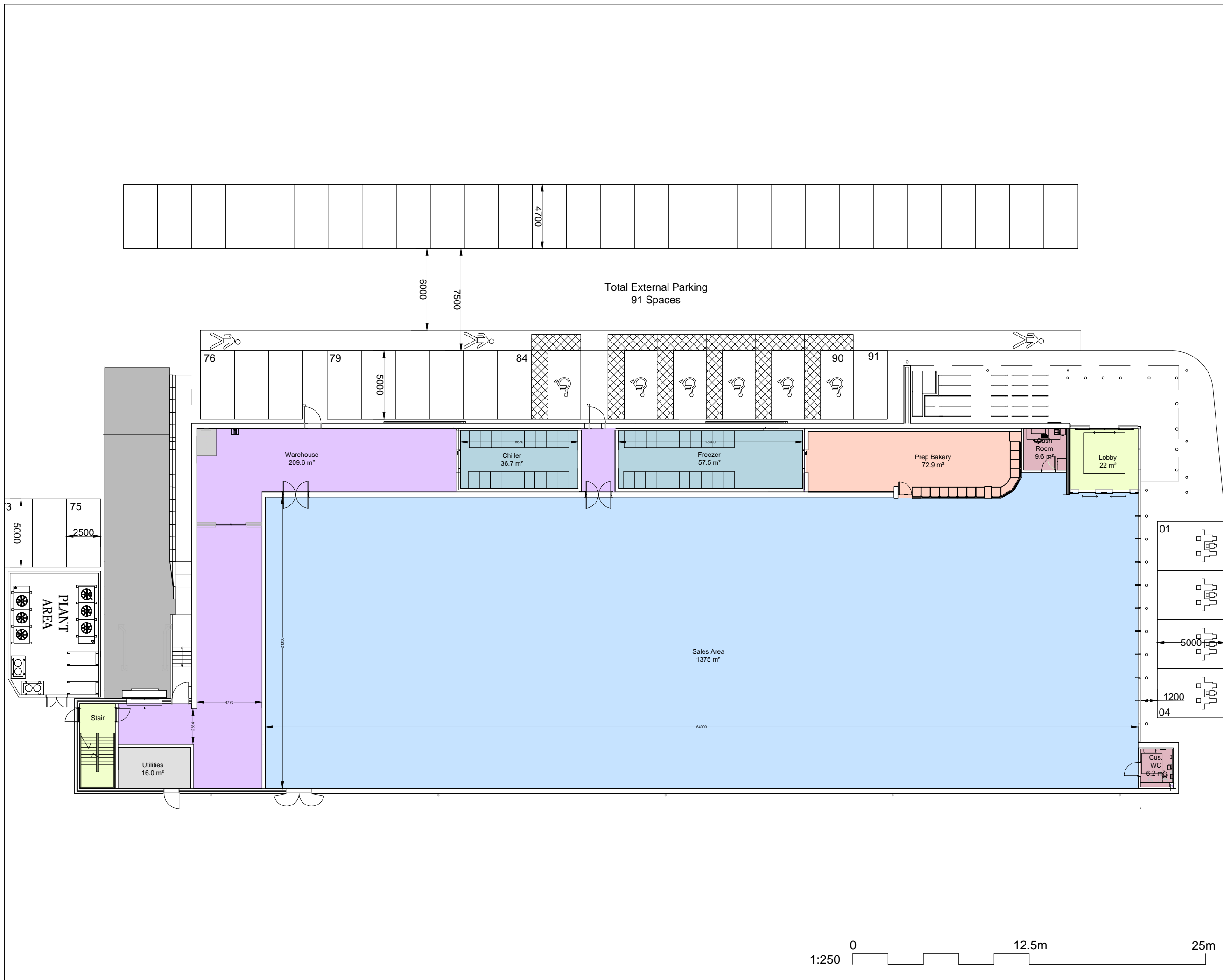

C:\Users\awilliams\OneDrive\Documents\Projects\Proposed Store Plan - Erith\Drawings\5508\_V01\_00\_DR\_A\_012011.dwg  
 20/06/2017 10:54:00